

# Instrument of Renewal

## Section 114 of the *Mining Act 1992*

I, **Jamie Tripodi, Executive Director, Assessments & Systems**, as delegate for the Minister administering the *Mining Act 1992* for the State of New South Wales, pursuant to section 114 of the *Mining Act 1992*, have determined to renew **Mining Lease 1461 (Act 1992)**, as described in Schedule 1, to **Donaldson Coal Pty Ltd, ACN 073 088 945**, subject to the conditions:

1. prescribed in the *Mining Act 1992* and the Mining Regulation 2016; and
2. set out in Schedule 2.

**Note:** For the avoidance of doubt, any prior Description of Lease and any Conditions imposed prior to the effective date of this Instrument of Renewal are replaced by Schedule 1 and 2 of this Instrument of Renewal on and from the effective date.

Signed this 12th day of May 2023



**Jamie Tripodi**  
**Executive Director**  
**Assessments & Systems**  
**Regional NSW**  
**As delegate for the Minister administering the *Mining Act 1992***  
**Delegation dated: 28 February 2023**

# SCHEDULE 1

## Description of Lease

<b>Mining lease:</b>	<b>1461 (Act 1992)</b>
<b>Renewal date:</b>	<b>12 May 2023</b>
<b>Effective date:</b>	<b>12 May 2023</b>
<b>Term ending (expiry date):</b>	<b>21 December 2040</b>
<b>Lease Holder(s)</b>	<b>Donaldson Coal Pty Ltd ACN 073 088 945</b>
<b>Land:</b>	The lease area includes all land described in the attached lease plan titled <b>M27132</b> and approved on <b>30 June 2009</b> .
<b>Area:</b>	<b>515.6 hectares</b>
<b>Surface Exception Depth Restriction:</b>	<b>Nil Part 30 metres and Part 900 metres below AHD</b>
<b>Mineral(s):</b>	<b>Coal</b>
<b>Method:</b>	<b>Open Cut</b>

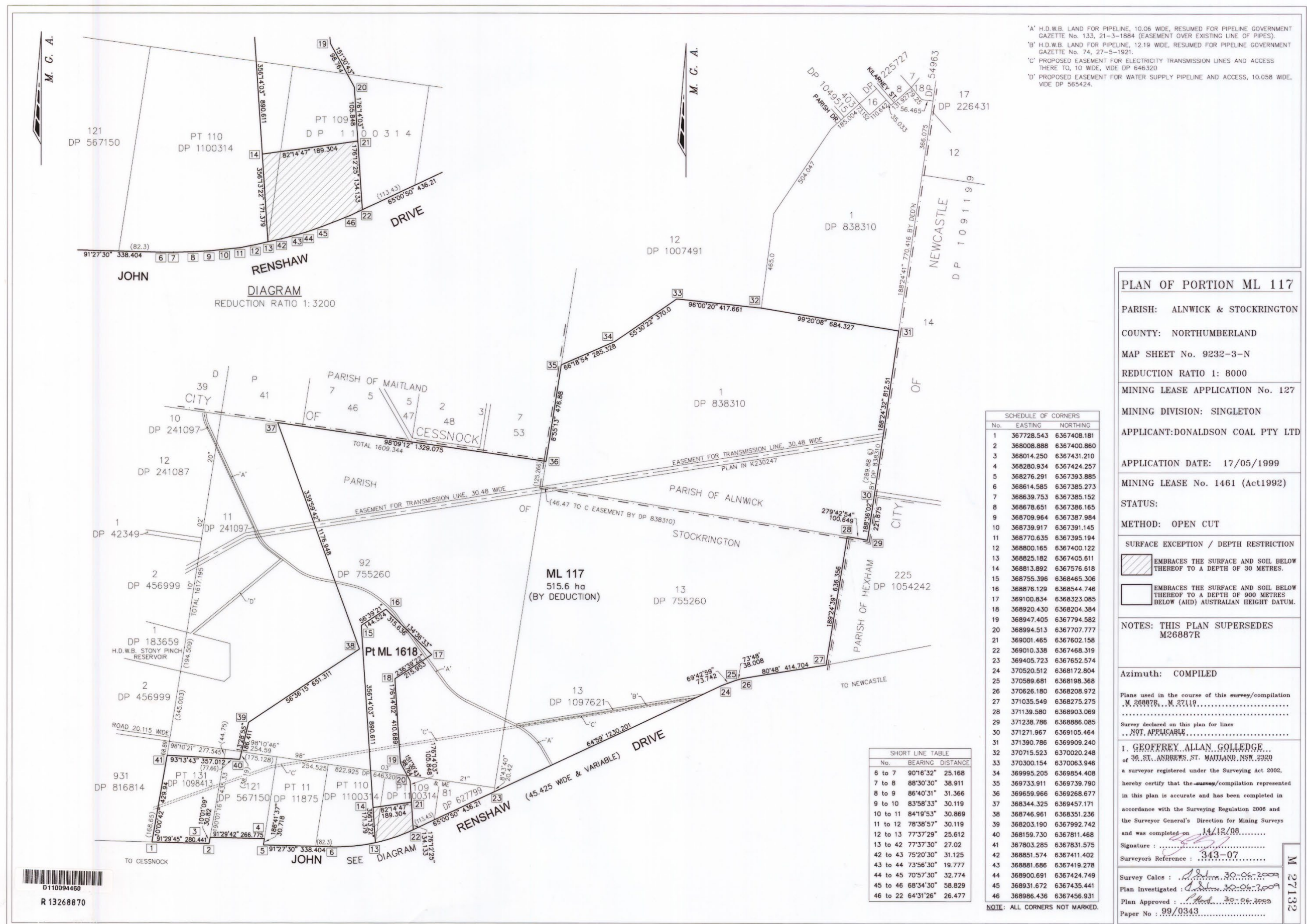

# SCHEDULE 2

## Mining Lease Conditions 2021

(Version 1.1 as at February 2022)

### Definitions

Words used in this mining lease have the same meaning as defined in the *Mining Act 1992* except where otherwise defined below:

Term	Definition
<b>Act</b>	means the <i>Mining Act 1992</i> .
<b>Landholder</b>	for the purposes of these conditions: <ul style="list-style-type: none"><li>• does not include a secondary landholder</li><li>• includes, in the case of exempted areas, the controlling body for the exempted area.</li></ul>
<b>Minister</b>	means the Minister administering the Act.

#### Note:

1. The rights and duties of the lease holder(s) are those prescribed by the *Mining Act 1992* and the Mining Regulation 2016, subject to the terms and conditions of this mining lease.
2. This mining lease does not override any obligation on the lease holder(s) to comply with the requirements of other legislation and regulatory instruments which may apply (including all relevant development approvals) unless specifically provided under the *Mining Act 1992* or other legislation or regulatory instruments.

# MINING LEASE CONDITIONS

## Standard conditions

See Mining Regulation 2016, Schedule 8A, Part 2.

**NOTE TO HOLDERS:** The prescribed standard conditions in the Mining Regulation 2016, Schedule 8A, Part 2 apply in addition to the conditions in this Schedule 2 (but have not been replicated in this mining lease). The conditions imposed by the Mining Regulation 2016 prevail to the extent of any inconsistency with the conditions in this Schedule 2.

## General conditions

### 1. Notice to Landholders

- (a) Within 90 days from the date of grant or renewal of this mining lease, the lease holder must give each landholder notice in writing:
- (i) that this mining lease has been granted or renewed; and
  - (ii) whether the lease includes the surface.

The notice must include a plan identifying the lease area and each landholder and individual land parcel within the lease area.

- (b) If there are ten or more landholders to which notice must be given, the lease holder will be taken to have complied with condition 1(a) if a notice complying with condition 1(a) is published in a newspaper circulating in the region where the lease area is situated.

### 2. Security

The lease holder is required to provide and maintain a security deposit to secure funding for the fulfilment of obligations under the mining lease, including obligations under the mining lease that may arise in the future.

The amount of the security deposit to be provided and maintained is **\$3,576,000**.

### 3. Cooperation Agreement

The lease holder must make every reasonable attempt, and be able to demonstrate its attempts to the satisfaction of the Secretary, to enter into a cooperation agreement with the holder(s) of any overlapping authorisations issued under the *Mining Act 1992* and petroleum titles issued under the *Petroleum (Onshore) Act 1991*. The cooperation agreement should address but not be limited to:

- access arrangements
- operational interaction procedures
- dispute resolution
- information exchange
- well location

Mining Lease Conditions 2021	Version Date: February 2022 (Version 1.1)
Mining Lease 1461 (Act 1992)	Page 5 of 6

- timing of drilling
- potential resource extraction conflicts; and
- rehabilitation issues.

#### 4. Assessable Prospecting Operations

- (a) The lease holder must not carry out any assessable prospecting operation on land over which this lease has been granted unless:
  - (i) it is carried out in accordance with any necessary development consent; or
  - (ii) if development consent is not required, the prior written approval of the Minister has been obtained.
- (b) The Minister may require the lease holder to provide such information as required to assist the Minister to consider an application for approval.
- (c) An approval granted by the Minister under this condition may be granted subject to terms.
- (d) The lease holder must comply with the approval granted to the holder under this condition.

#### Exploration Reporting

**Note:** Exploration Reports (Geological and Geophysical)

The lease holder must lodge reports in accordance with the requirements in section 163C of the *Mining Act 1992* and clauses 59, 60 and 61 of the Mining Regulation 2016 as well as any further requirements issued by the Secretary under clause 62 of the Mining Regulation 2016.

Guidelines for the structure, content and data format requirements for reports are set out in the *Exploration Reporting: A guide for reporting on exploration and prospecting in New South Wales*.

Mining Lease Conditions 2021	Version Date: February 2022 (Version 1.1)
Mining Lease 1461 (Act 1992)	Page 6 of 6